

1. Product must meet cosmetic standard requirements (Category A, B or C) specified in ABB Cosmetic standards procedure C02-QAM.001.2.
2. Supplier's first article inspection must comply with FAI procedure C04-QAM.002.2.
3. Dimensions specified in oval are critical to function and require inspection plan.
4. Dimensional Quality shall be DPI 3.3 MIN. Provide report for minimum 30 pcs batch.
5. For missing dimensions, refer to individual CAD file for 3-D geometry.
6. Labeling requirements: Specification UAF.01506 (Class Component QRC).
7. Hatched surfaces to be free of all scratches, ejector marks and sink marks.
8. To prevent damage in shipment and handling, parts shall be adequately packaged in cell type separators, protective wrapped as required.

No wrap zone



ABB	Material	SEE NOTES	General tolerances according to ISO 2768							
	Treatment	SEE NOTES	Geometric	Dimensional	0.5-3	3-6	6-30	30-120	120-400	400-1000
Material used, treatments and finished product must meet the requirements of the current RoHS directive of the European Union.	Weight	Kg	X	K	X	m	f	c	l	l
			±0.1	±0.1	±0.2	±0.3	±0.5	±0.8	±1.2	±2
Title			Size	Scale	UoM	Sheet	First-angle projection	Chamfers non quoted 0.5x45°		
T184 CABINET; ADA DOOR			Kg	A1	1:12 mm	1/2	⊕	Files non quoted R0.5mm		
Drawing No.			Approved			Revision			Revision	
YVD.S11AB.0DG			11/02/23			K.MALLAVARAPU			SEMBOLONI A.	
AA			11/02/23			SEMBOLONI A.			AA	

Last saved: USAWALL1

1. Product must meet cosmetic standards requirements (Category A, B or C) specified in ABB Cosmetic standards procedure C02-QAM.001.2
2. Supplier's first article inspection must comply with FAI procedure C04-QAM.002.2
3. Dimensions specified in oval are critical to function and require inspection plan.
4. Dimensional Quality shall be DPI 3.3 MIN. Provide report for minimum 33pcs batch.
5. For missing dimensions, refer to individual CAD file for 3-D geometry.
6. Labeling requirements: Specification LAMP.01506 (Class Component QRC).
7. Noted surfaces to be free of all scratches, ejector marks and sprue marks.
8. To prevent damage in shipment and handling, part(s) shall be adequately packaged in cell type separators, protective wrapped as required.

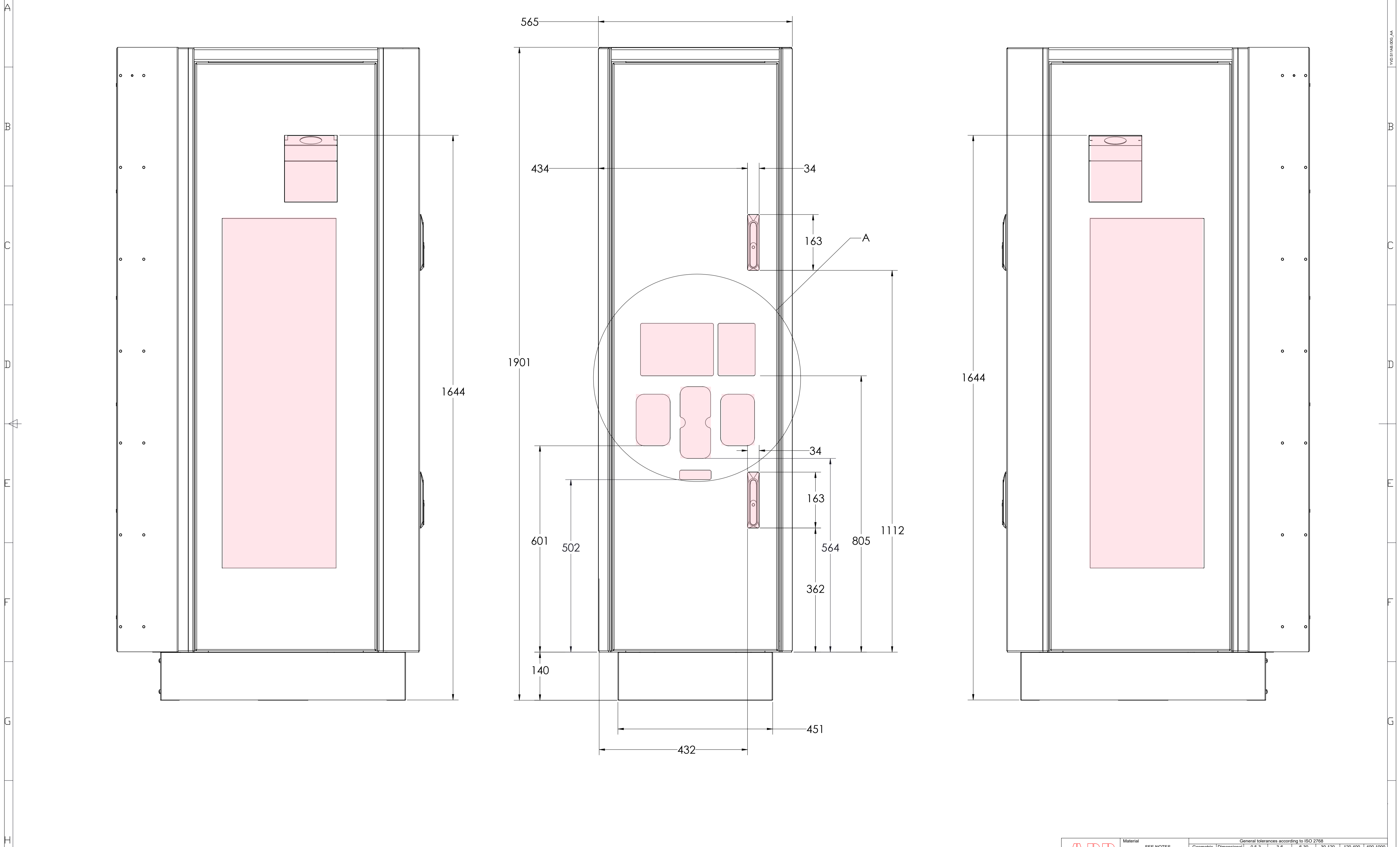
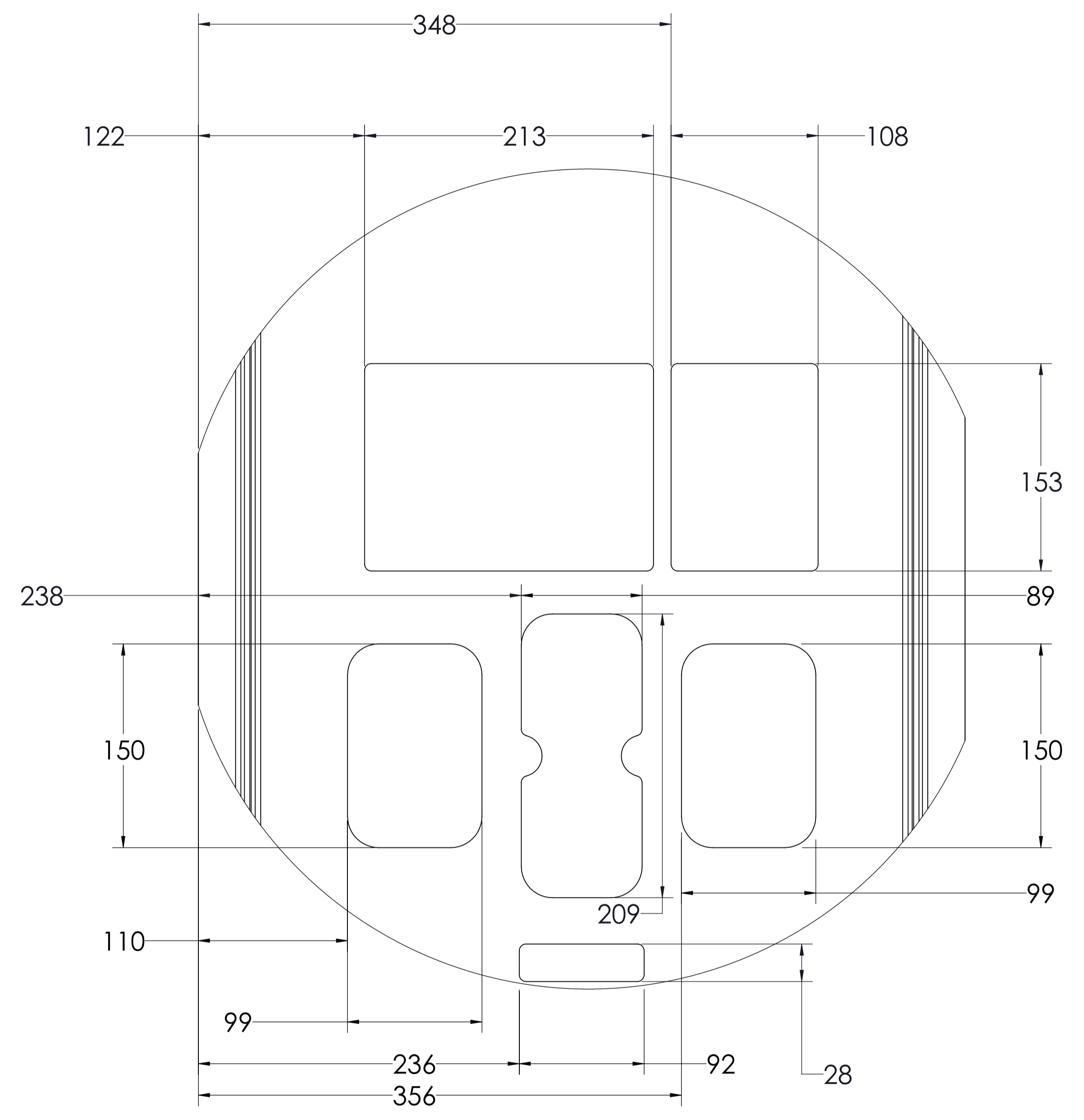

DETAIL A
SCALE 2 : 5

ABB	Material	SEE NOTES	General tolerances according to ISO 2768								
	Treatment	SEE NOTES	Geometric	Dimensional	0.5-3	3-6	6-30	30-120	120-400	400-1000	
Material used, treatments and finished product must meet the requirements of the current RoHS directive of the European Union.	Weight	Kg	A1	1:12 mm	2/2	First-angle projection	Charfers non quoted 0.5x45°			Filets non quoted R=0.5mm	
							Size	Scale	UoM	Sheet	Issued
Title		T184 CABINET; ADA DOOR		Drawing No.		YVD.S11AB.0DG		Revision		AA	